



K33 Lithium Off-grid System

Off-grid, Remote Power

www.ecocool.com.au

ecoCool's **K33 Lithium Offgrid System** is a complete, Victron based Energy System for your off-grid residence. The K33 allows you to be up and running quickly with plug-and-play elements, using the Victron eco-system. Upgradable in 5KWh modules, in a neat IP rated enclosure.

The K33 off-grid system uses Victron's MultiplusII Inverter/Charger, Cerbo GX, and ecoCool's E30 energy dashboard. With internal (or external) MPPT solar controllers, (an extra you choose) and a 15A Generator inlet.



| Models: | K33.3000.G.50 K33.3000.G.100 | K33.5000.G.100 K33.5000.G.150 | K33.8000.G.150 K33.10000.G.200 K33.15000.G.200 K33.30000.G.300 K33.45000.G.500 |
|-----------------------------|--|----------------------------------|--|
| Single/Three Phase | 1 phase | 1 phase | 1 & 3 phase |
| Output: | Output Voltage: 230V a.c. Frequency: 50Hz* | | |
| Output Power (at 25°C): | 3000VA / 2400W | 5000VA / 4000W | 8 / 10 / 15 / 30 / 45KVA |
| Max. Input Current: | 32 A | 50 A | 100 A+ |
| Use Application: | Off-grid Off-grid | On-grid Off-grid | On-grid Off-grid |
| Battery | | | |
| Battery Capacity KWh: | 5 10 15 | 10 15 | 5 10 15 20 25 30 |
| Battery Size (Ah): | 100 200 | 200 300 | 300 400 500 600 1000 |
| Battery Nom. Voltage: | 51.2V d.c. (48V Nom.) | | |
| Battery Type | LiFePO4 (Lithium) | | |
| Enclosure | | | |
| Enclosure type: | Galvanised Steel Steel (S/Steel 316 optional) | | |
| Enclosure colour: | Powdercoated Light Grey, RAL7035 | | |
| Enclosure (5-10kWh) mm: | 885Hx800Wx400D | 885Hx800Wx400D + | 1285Hx800Wx400D + |
| Expans. Enclosure mm: | 600Hx600Wx400D | 600Hx600Wx400D | 600Hx600Wx400D + |
| Weight (kg): | 138 174 210 | 194 230 266 302 338 | 260 296 332 368 404 |
| Warranty | Inverter, System: 5 Yrs, Lithium Battery: 10 Yrs | | |
| Cont. output power at 25°C: | 2400W | 4000W | 6.4KW 8KW 12KW + |
| Cont. output power at 40°C: | 2200W | 3700W | See Victron Datasheet |
| Peak power (0.5 sec.): | 5500W | 9000W | See Victron Datasheet |

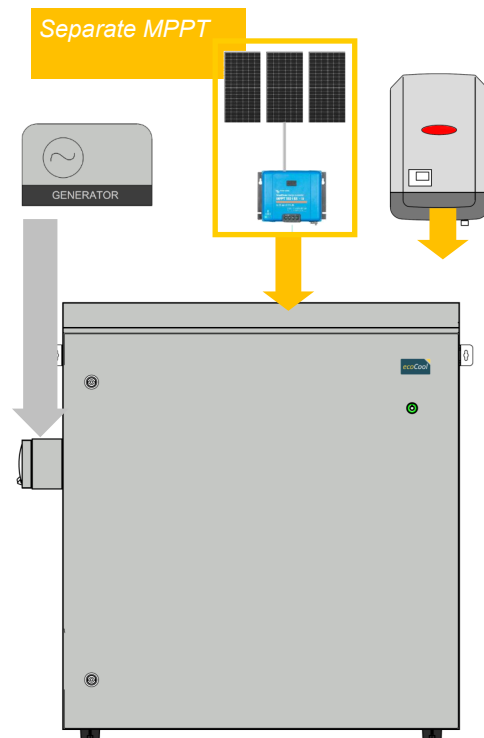

K33 Lithium Offgrid System

Off-grid, Remote Power

Features:

- High Quality Lithium Battery
- Upgradable in 5KWh modules
- IP Rated Enclosure IP54
- Quality Victron Inverters, Cerbo GX, Victron Display options
- Generator inlet, 10/15A Plug Outlet
- External Access DC isolators & AC breakers
- Energy Management dash boards: E30 / Victron Touch
- Designed & Assembled in Australia
- MPPT included standard
- Victron ecosystem options
- MPPT Embedded or External

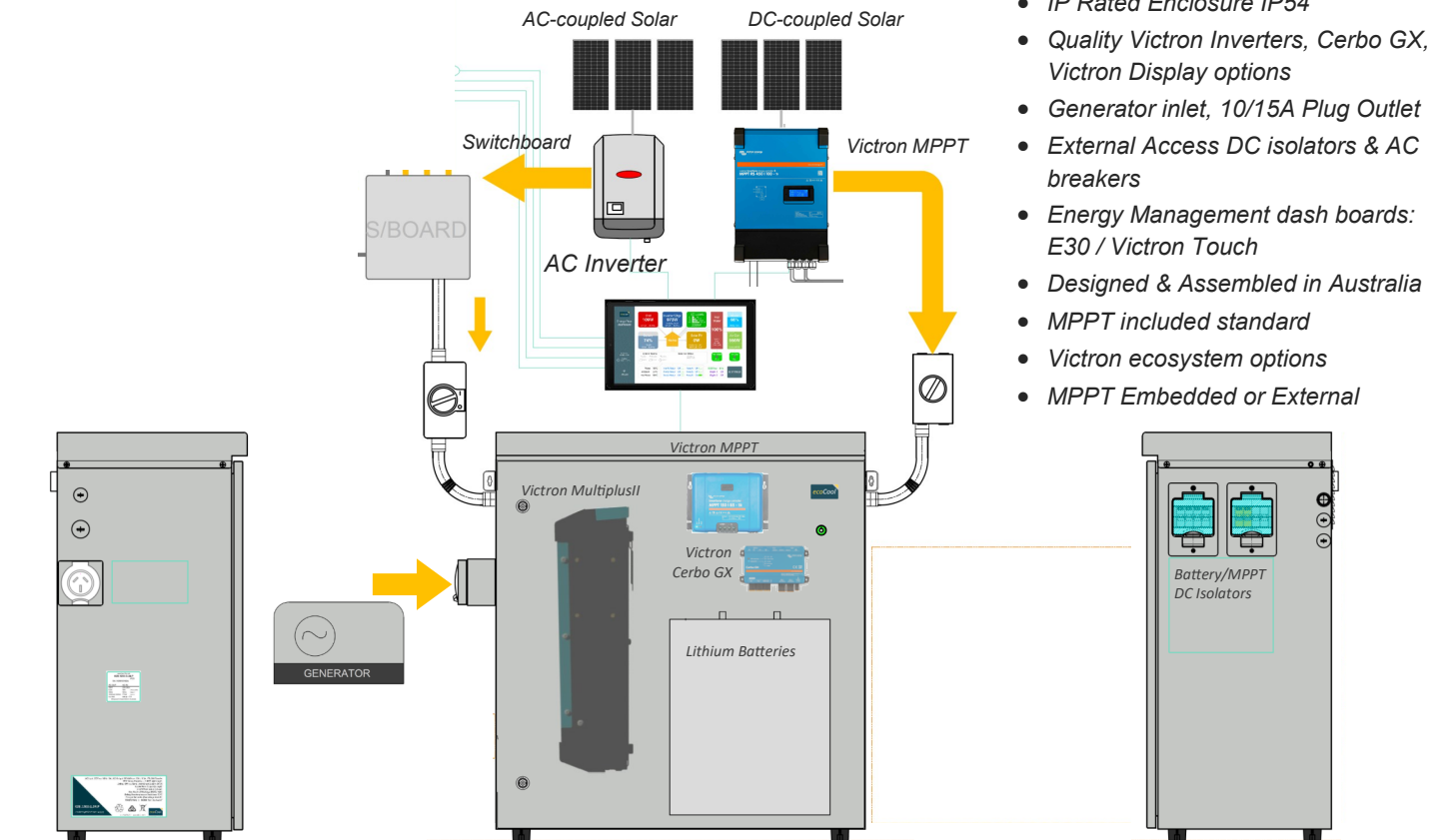

| Model: | Specifications | Casing Size | 500W.Hrs | KWh | Inverter | MPPT | Battery | Control |
|-------------------|--|------------------|-----------|--------|-------------|--------------|-------------|---------|
| K33.3000.G.50 | Lithium Battery 5 KWh, 3000VA Output | 885Hx800Wx400D | 10 hours | 5 KWh | Multi 3KVA | Int/External | Vaulta 5KWh | GX+E30 |
| K33.3000.G.100 | Lithium Battery 10 KWh, 3000VA Output | 885Hx800Wx400D | 20 hours | 10 KWh | Multi 3KVA | Int/External | Vaulta 5KWh | GX+E30 |
| K33.5000.G.100 | Lithium Battery 10 KWh, 5000VA Output | 885Hx800Wx400D | 20 hours | 10 KWh | Multi 5KVA | Int/External | Vaulta 5KWh | GX+E30 |
| K33.5000.G.150 | Lithium Battery 15 KWh, 5000VA Output | 885Hx800Wx400D | 30 hours | 15 KWh | Multi 5KVA | Int/External | Vaulta 5KWh | GX+E30 |
| K33.8000.G.150 | Lithium Battery 15 KWh, 8000VA Output | 1085Hx800Wx400D | 30 hours | 15 KWh | Multi 8KVA | Int/External | Vaulta 5KWh | GX+E30 |
| K33.10000.G.200 | Lithium Battery 20 KWh, 10000VA Output | 2120Hx600Wx600D | 40 hours | 20 KWh | Multi 10KVA | External | Vaulta 5KWh | GX+E30 |
| K33.15000.G.250 | Lithium Battery 25 KWh, 15000VA Output | 2120Hx600Wx600D | 50 hours | 25 KWh | Multi 15KVA | External | Vaulta 5KWh | GX+E30 |
| K33.15000-3.G.250 | Lithium Battery 25 KWh, 15000VA 3ph Output | 2120Hx600Wx600D | 50 hours | 25 KWh | Multi 15KVA | External | Vaulta 5KWh | GX+E30 |
| K33.30000-3.G.300 | Lithium Battery 30 KWh, 30000VA 3ph Output | 2120Hx800Wx600D | 60 hours | 30 KWh | Multi 30KVA | External | Vaulta 5KWh | GX+E30 |
| K33.45000-3.G.500 | Lithium Battery 50 KWh, 45000VA 3ph Output | 2120Hx1000Wx800D | 100 hours | 50 KWh | Multi 45KVA | External | Vaulta 5KWh | GX+E30 |

Quality Components:

- Victron MultiplusII Inverter/Charger
- Victron Cerbo GX Controller
- Victron Solar MPPT (150/45 Smart)
- Vaulta or BYD 5KWh Lithium Battery
- ecoCool E30 Dashboard Options
- Victron ecosystem options

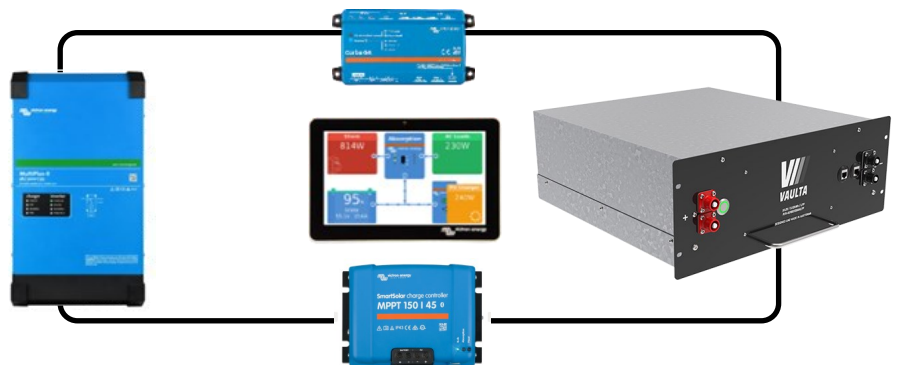

ecoCool Pty Ltd
 4/30 Fremantle St,
 Burleigh Heads Qld 4220
 p +61 7 5525 5964
 e info @ ecoCool.com.au
 www.ecocool.com.au